

wooden frame  
plywood

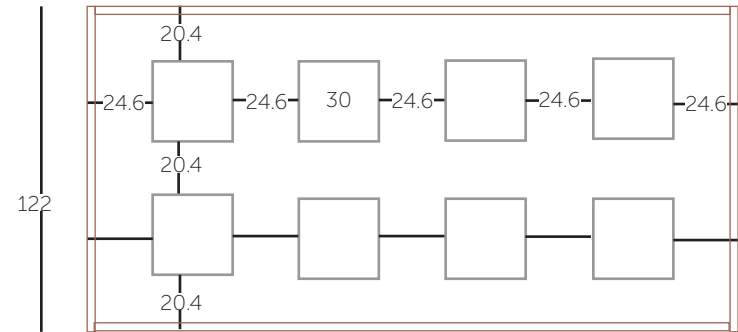

drawing shows canopy with wooden frame

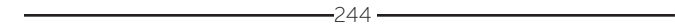
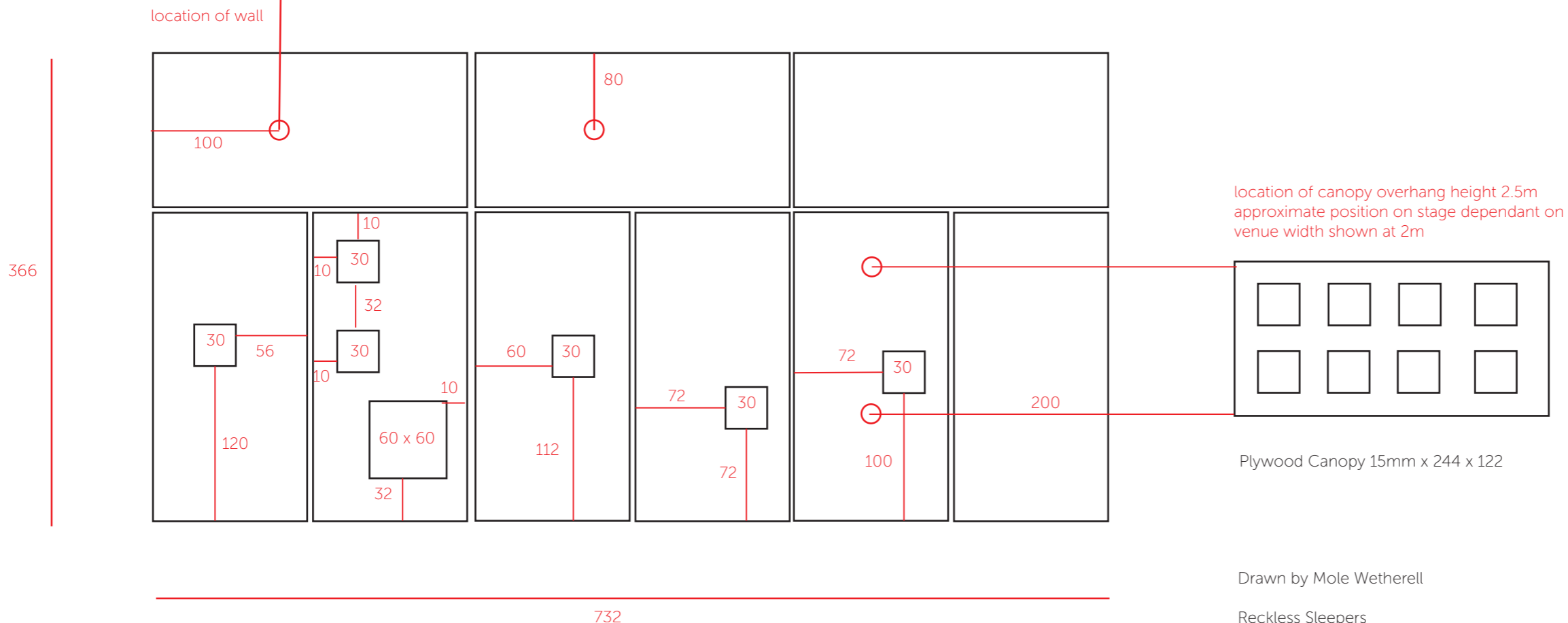
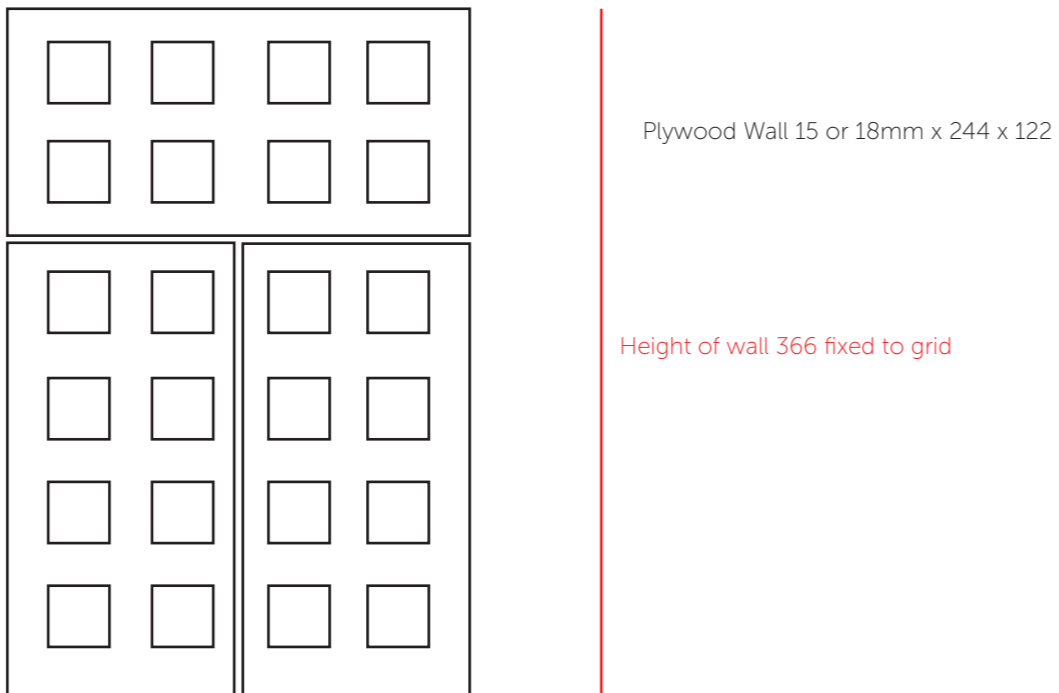

Plywood floor 15 or 18mm x 244 x 122

Elliot Pine Structural Grade Plywood - 2440mm x 1220mm x 15 / 18mm (CE2+ C+/C FSC)

Drawn by Mole Wetherell

Reckless Sleepers  
+32 473928158  
mw@reckless-sleepers.co.uk

[www.reckless-sleepers.eu](http://www.reckless-sleepers.eu)

Hi resolution images for reference  
<https://www.flickr.com/photos/reckless-sleepers/albums/72157691442073453>

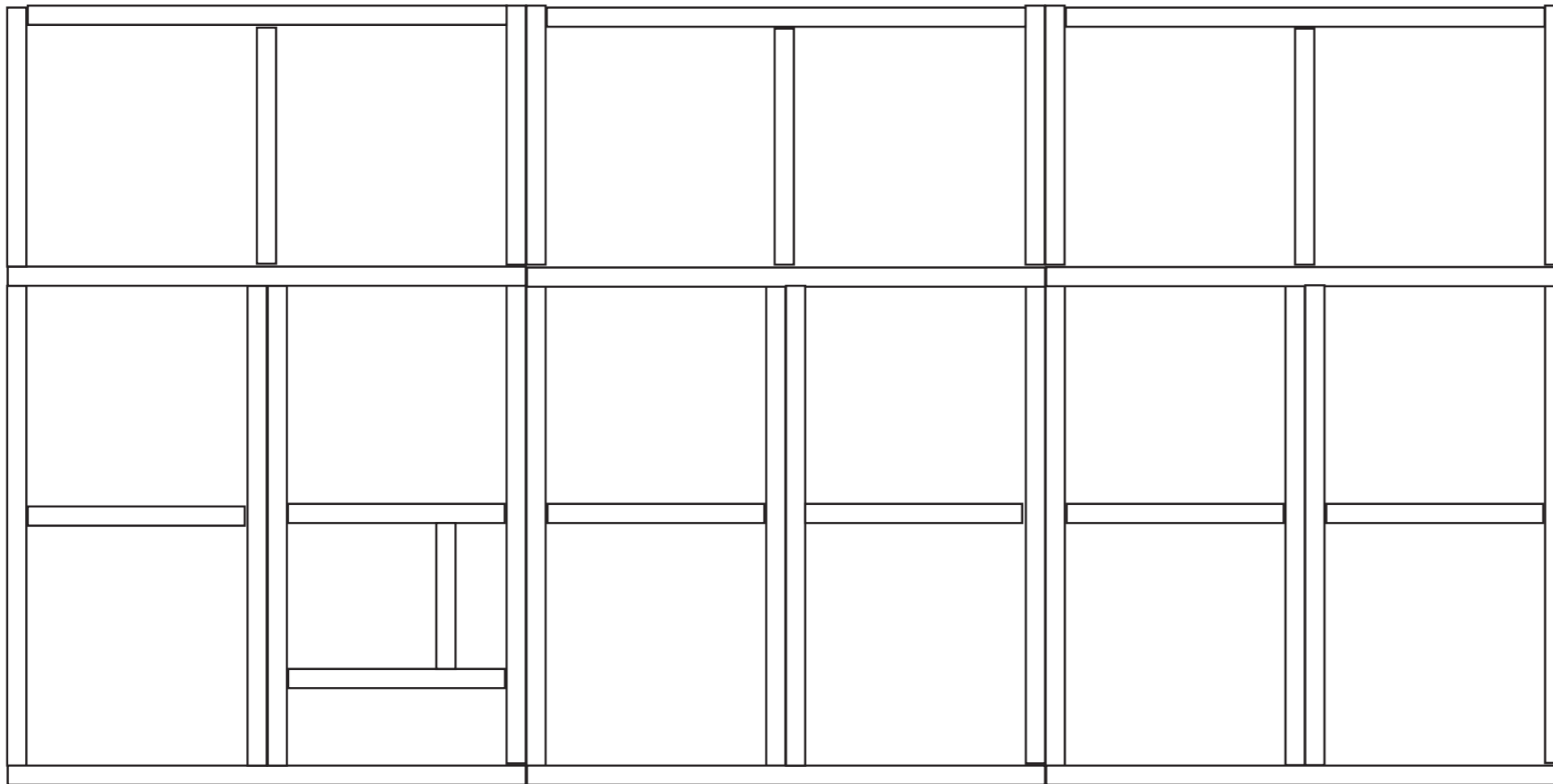

Underfloor CLS Stud wall timber 270 x 89 x 38

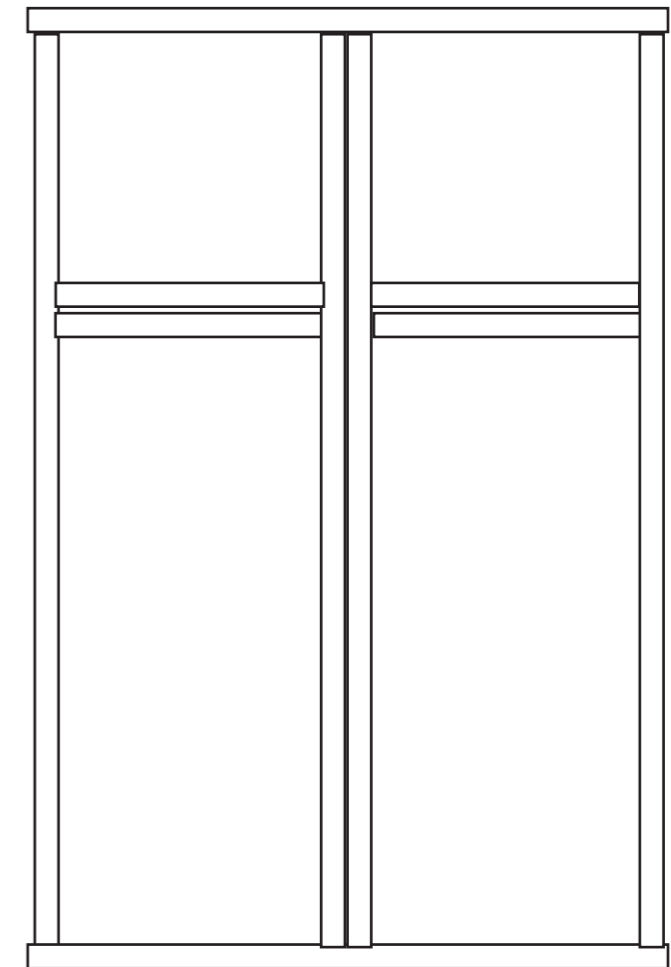

Wall CLS Stud wall timber 360x 89 x 38

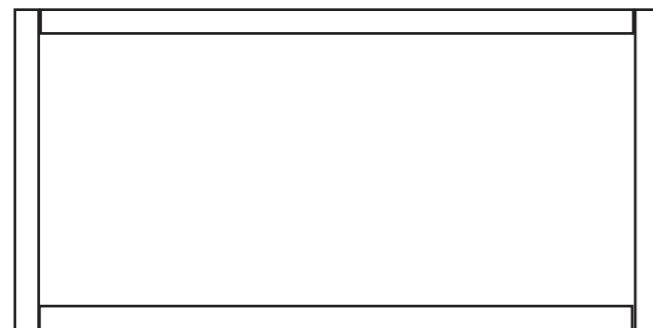

Canopy CLS Stud wall timber 240 x 89 x 38

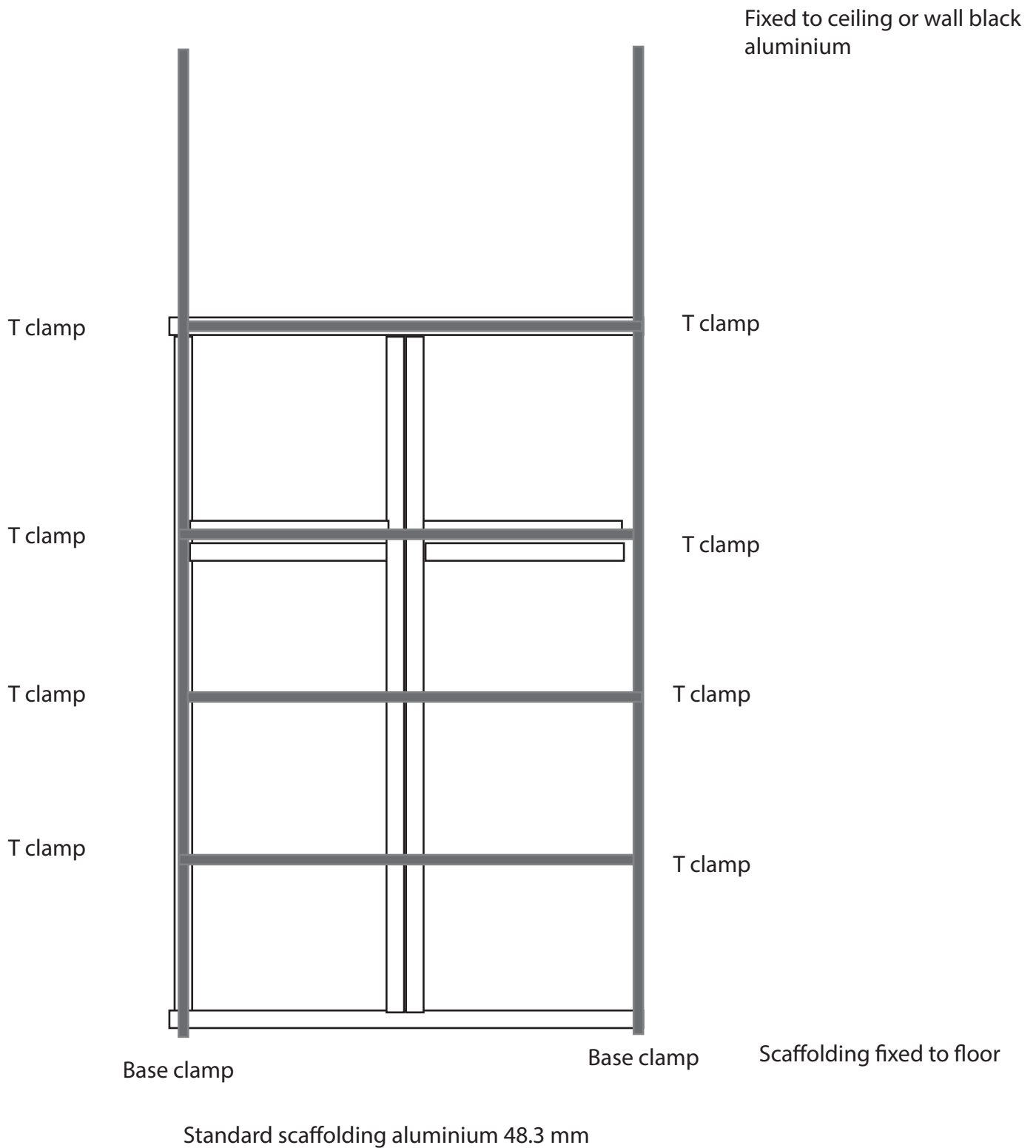

Wall fixed to scaffolding using key clamps.

Scaffolding fixed to floor using base clamps

Right angle clamps for climbing bars x 2

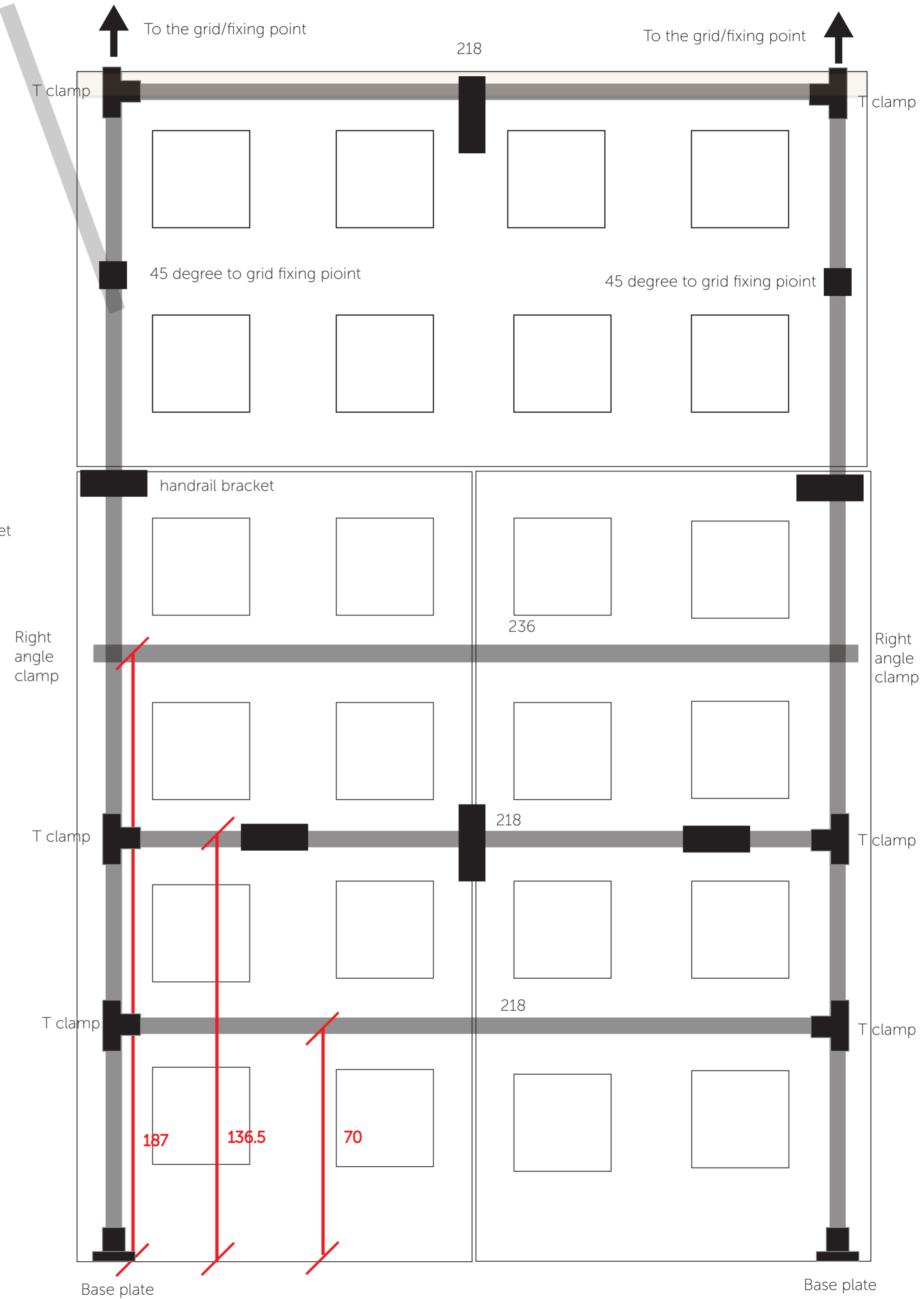
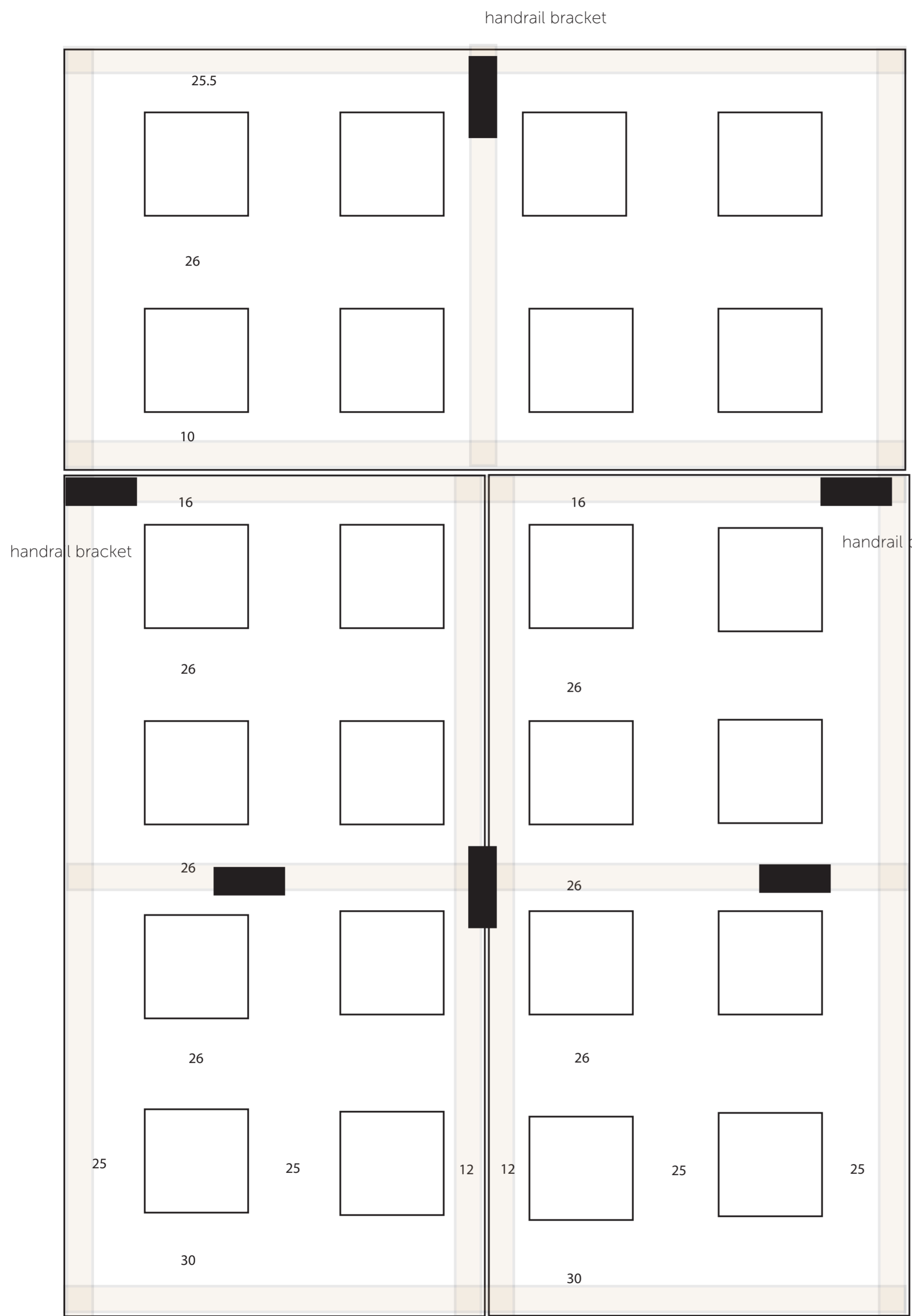

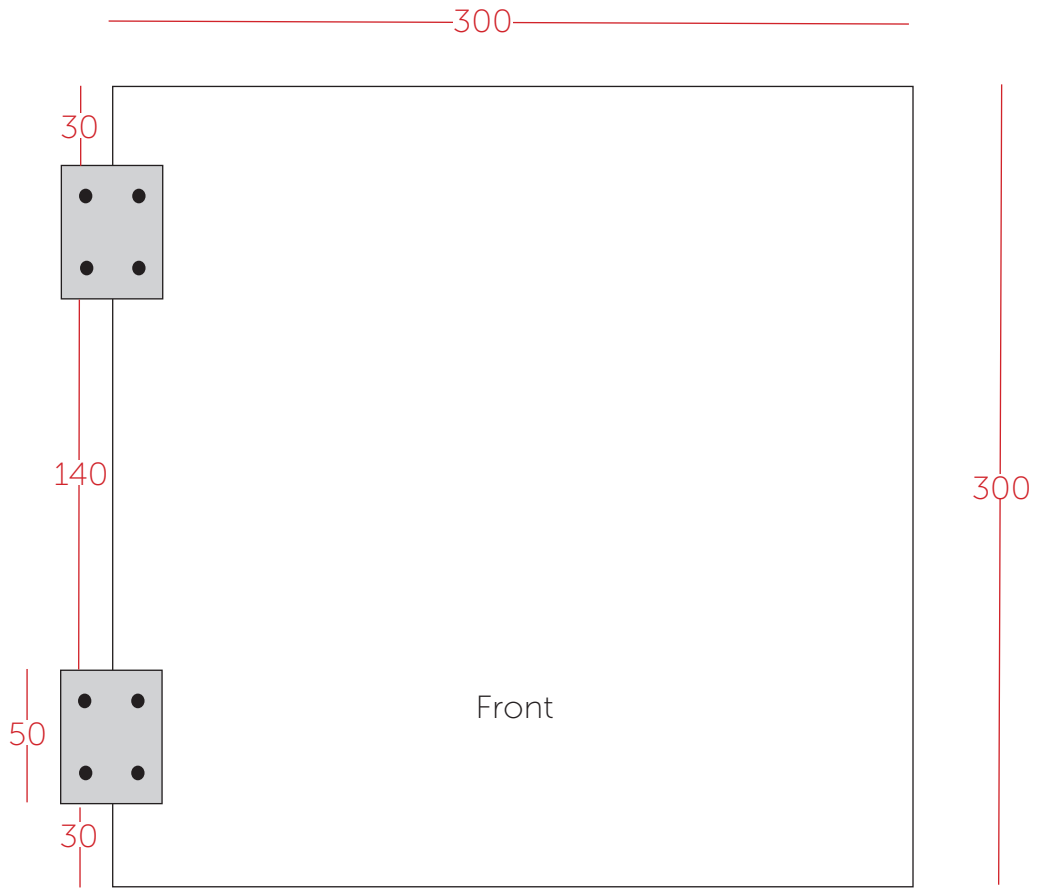

—38—

